

FOR SALE – Offers Over £120,000

**Lime Tree House, St Johns Road, Shildon, Co.
Durham, DL4 1LU**

Period Dental Practice – 1,329sq.ft.

CARVER

COMMERCIAL

CHARTERED SURVEYORS
& PROPERTY CONSULTANTS



www.carvercommercial.com



SITUATION/LOCATION

St Johns Road is a predominantly residential street situated adjacent to Hackworth Park approximately 0.5 miles from Shildon town centre. Shildon is a popular town and civil parish situated approximately 5 miles south of Bishop Auckland, 14 miles north of Darlington and 15 miles east of Barnard Castle. Shildon benefits from swift transport links across the region via with access to the A68 and A167 linking with A1(M) within a short driving distance.

DESCRIPTION

Two storey period dental practice of traditional stone construction held under a hip pitched concrete pan tile covered roof forming the end of a terrace of similar properties.

Internally the ground floor is arranged to provide a former reception, two surgeries and staff ancillary accommodation. There are two surgeries, office and kitchen on the first floor.

The property predominantly incorporates double glazed UPVC sash windows and is heated by way of a gas fired central heating system.

There is a small enclosed yard at the rear with access from the lane.

TENURE

Freehold

ACCOMMODATION

Ground Floor: 66.79sq.m. (719sq.ft.)

First Floor: 56.66sq.m. (610sq.ft.)

Net Internal Area: 123.45sq.m. (1,329sq.ft.)

RATEABLE VALUE

£12,250

The property falls within the threshold for small business relief and eligible occupiers should benefit from an element of relief from business rates. Interested parties are advised to direct further enquiries to the Local Rating Authority.

VAT

We are advised by our client that VAT is not applicable to the purchase price.

VIEWING

Strictly by appointment only through agents.

ENERGY PERFORMANCE ASSET RATING

E-119



18 St Cuthberts Way
Darlington,
County Durham
DL1 1GB
Telephone: 01325 466945

IMPORTANT NOTICE: whilst every reasonable effort has been made by Carver Commercial to ensure accuracy, interested parties are strongly advised to take appropriate steps to verify by independent inspection or enquiry all information for themselves and to take appropriate professional advice. (i) No description or information given about the property or its value, whether written or verbal or whether or not in these particulars ('information') may be relied upon as a statement of representation or fact. Carver Commercial or any joint agent nor its employees have any authority to make any representation and accordingly any information given is entirely without responsibility on the part of the Agent or the seller/lessor. (ii) Any photographs show only certain parts of the property at the same time they were taken. Any areas, measurements or distances given are approximate only. (iii) Any reference to alterations to, or use of any part of the property is not a statement that any necessary planning, building regulations or other consent has been obtained. These matters must be verified by any intending buyer/lessee. (iv) Any buyer/lessee must satisfy himself by inspection or otherwise as to the correctness of any information given. (v) VAT is applicable unless expressly stated otherwise.

CARVER
COMMERCIAL
CHARTERED SURVEYORS
& PROPERTY CONSULTANTS



FLOOR PLANS

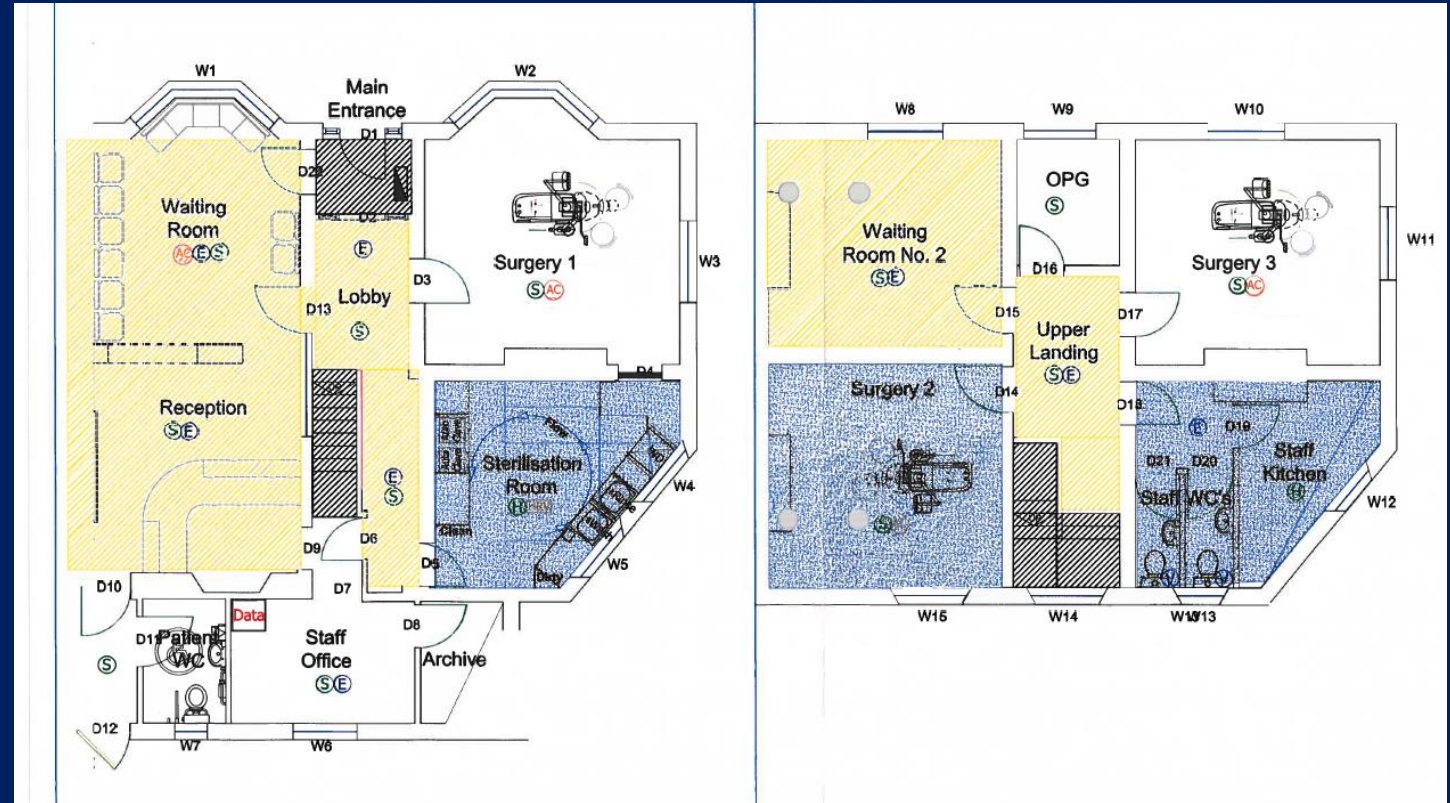

**18 St Cuthberts Way
Darlington,
County Durham
DL1 1GB
Telephone: 01325 466945**

IMPORTANT NOTICE: whilst every reasonable effort has been made by Carver Commercial to ensure accuracy, interested parties are strongly advised to take appropriate steps to verify by independent inspection or enquiry all information for themselves and to take appropriate professional advice. (i) No description or information given about the property or its value, whether written or verbal or whether or not in these particulars ('information') may be relied upon as a statement of representation or fact. Carver Commercial or any joint agent nor its employees have any authority to make any representation and accordingly any information given is entirely without responsibility on the part of the Agent or the seller/lessor. (ii) Any photographs show only certain parts of the property at the same time they were taken. Any areas, measurements or distances given are approximate only. (iii) Any reference to alterations to, or use of any part of the property is not a statement that any necessary planning, building regulations or other consent has been obtained. These matters must be verified by any intending buyer/lessee. (iv) Any buyer/lessee must satisfy himself by inspection or otherwise as to the correctness of any information given. (v) VAT is applicable unless expressly stated otherwise.

CARVER
COMMERCIAL
CHARTERED SURVEYORS
& PROPERTY CONSULTANTS