



CARVER
RESIDENTIAL
Sales · Lettings · Property Management

Main Road
Gainford, Darlington, DL2 3DY

Offers in the region of £195,000

Cottage
2 Bedroom/s
1 Bathroom/s

Nestled in the charming village of Gainford, on the outskirts of Darlington, Chaytor Cottage presents a delightful opportunity for those seeking a blend of modern comfort and traditional character. This impressive cottage has been thoughtfully improved, ensuring it retains its unique charm while offering contemporary living.

Upon entering, you are welcomed into a cosy living room, complete with a log burner that creates a warm and inviting atmosphere, perfect for relaxing evenings. The heart of the home is undoubtedly the stunning open-plan kitchen and dining area, which provides an ideal space for entertaining family and friends. The kitchen is well-equipped, making it a joy for any home cook.

The property boasts two generously sized bedrooms, each offering a peaceful retreat for rest and relaxation. The refitted bathroom is modern and stylish, providing all the necessary amenities for your convenience.

One of the standout features of Chaytor Cottage is the south-facing rear courtyard, which invites plenty of natural light and offers a lovely outdoor space for enjoying the sunshine or hosting gatherings.

This cottage is not just a home; it is a lifestyle choice, set in a picturesque village that enhances its appeal. With its perfect blend of character, comfort, and modernity, Chaytor Cottage is an exceptional find for anyone looking to settle in this delightful area.





- FABULOUS COTTAGE, SYMPATHETICALLY REFURBISHED
- READY TO MOVE INTO
- TWO RECEPTION ROOMS DINING ROOM WITH LOG BURNER
- SUITED TO A VARIETY OF BUYERS
- PICTURESQUE VILLAGE LOCATION
- RETAINING CHARM AND CHARACTER
- STUNNING OPEN PLAN KITCHEN/DINER
- SOUTH FACING REAR COURTYARD
- NO ONWARD CHAIN

GENERAL INFORMATION

Tenure: Freehold

Services: gas central heating, mains electric, water and drainage.

Double glazing

Local Authority: Darlington (Tax Banding B)

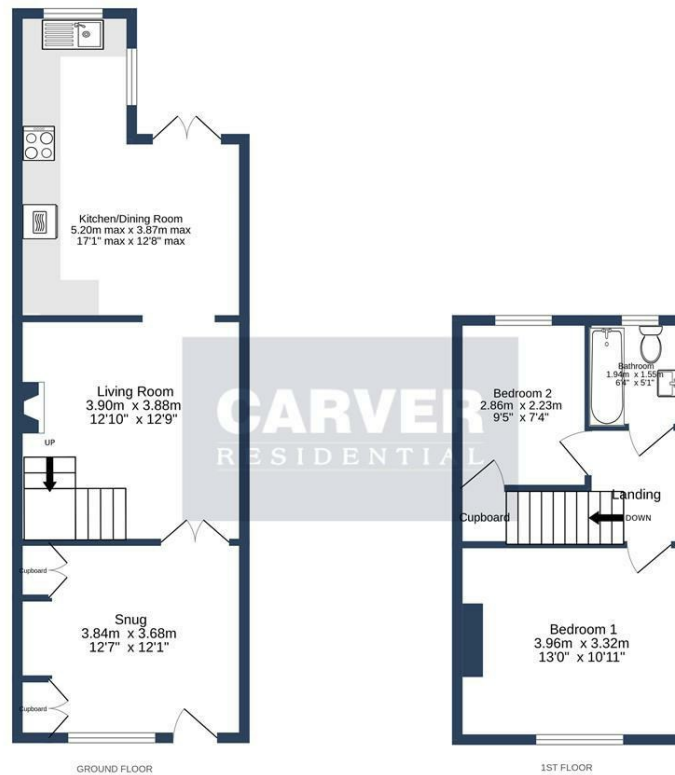

MAIN ROAD, GAINFORD, DL2 3DY.

Whilst every attempt has been made to ensure the accuracy of the floorplan contained here, measurements of doors, windows, rooms and any other items are approximate and no responsibility is taken for any error, omission or mis-statement. This plan is for illustrative purposes only and should be used as such by any prospective purchaser. The services, systems and appliances shown have not been tested and no guarantee as to their operability or efficiency can be given. Made with Metropix ©2025

| Energy Efficiency Rating | | |
|---|-------------------------|-----------|
| | Current | Potential |
| Very energy efficient - lower running costs | | |
| (92 plus) A | | 82 |
| (81-91) B | | |
| (69-80) C | | |
| (55-68) D | 62 | |
| (39-54) E | | |
| (21-38) F | | |
| (1-20) G | | |
| Not energy efficient - higher running costs | | |
| England & Wales | EU Directive 2002/91/EC | |

We can search 1,000s of mortgages for you

It could take just 15 minutes with one of our specialist advisers:
 Call: 01325 380088. Visit: Any of our Offices. Online: www.mortgageadvicebureau.com/carver



Your home may be repossessed if you do not keep up repayments on your mortgage. There will be a fee for mortgage advice. The actual amount you pay will depend upon your circumstances. The fee is up to 1% but a typical fee is 0.3% of the amount borrowed

MAB 6202



These particulars do not constitute any part of an offer or contract. None of the statements contained in these particulars are to be relied on as statements or representations of fact and any intending purchaser must satisfy himself by inspection or otherwise to the correctness of each of the statements contained in these particulars. The vendor does not make or give, and neither Nick & Gordon Carver Residential or Commercial, Nick & Gordon Carver, nor any person in their employment has any authority to make or give any representation or warranty whatever in relation to this property



14 Duke Street, Darlington
 County Durham, DL3 7AA
 Tel: 01325 357807
sales@carvergroup.co.uk

26 Market Place, Richmond
 North Yorkshire, DL10 4QG
 Tel: 01748 825317
richmond@carvergroup.co.uk

43 Dalton Way, Newton Aycliffe
 County Durham, DL5 4DJ
 Tel: 01325 320676
aycliffe@carvergroup.co.uk

219 High Street, Northallerton
 North Yorkshire, DL7 8LW
 Tel: 01609 777710
northallerton@carvergroup.co.uk

www.carvergroup.co.uk