



CARVER
RESIDENTIAL
Sales · Lettings · Property Management

St. Andrews Close
Aycliffe Village, DL5 6NA

Offers in the region of £155,000

House - Terraced
3 Bedroom/s
1 Bathroom/s

Occupying a lovely position overlooking Aycliffe Village Green this 3 BEDROOM family home features a ground floor rear extension incorporating a further reception room and WC and a first floor wet room/WC. Offered for sale with NO ONWARD CHAIN the property includes a living room overlooking the village green, kitchen/dining room and three bedrooms to the first floor. Externally there are gardens to both the front and rear whilst the property is also equipped with gas central heating to radiators and uPVC double glazing. The property, which is in need of modernisation throughout, enjoys a most conveniently placed village setting close to Darlington, Newton Aycliffe and the A1(M).





Agents Notes

Tenure:- Freehold

Mains gas, (central heating to radiators), electricity & drainage

uPVC double glazing throughout

Council Tax:- Band A

Local Authority:- Durham County Council

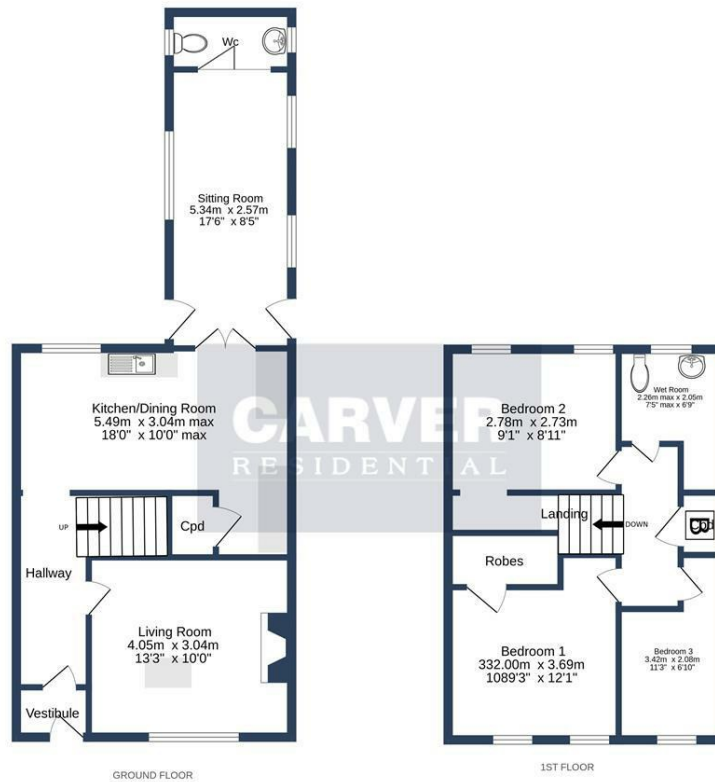

ST ANDREWS CLOSE, AYCLIFFE VILLAGE, DL5 6NA

Whilst every attempt has been made to ensure the accuracy of the floorplan contained here, measurements of doors, windows, rooms and any other items are approximate and no responsibility is taken for any error, omission or mis-statement. This plan is for illustrative purposes only and should be used as such by any prospective purchaser. The services, systems and appliances shown have not been tested and no guarantee as to their operability or efficiency can be given. Made with Metropix ©2021

Energy Efficiency Rating		Current	Potential
Very energy efficient - lower running costs			
(92 plus) A			
(81-91) B			
(69-80) C			
(55-68) D			
(39-54) E			
(21-38) F			
(1-20) G			
Not energy efficient - higher running costs			
England & Wales		EU Directive 2002/91/EC	

We can search 1,000s of mortgages for you

It could take just 15 minutes with one of our specialist advisers:
 Call: 01325 380088. Visit: Any of our Offices. Online: www.mortgageadvicebureau.com/carver



Your home may be repossessed if you do not keep up repayments on your mortgage. There will be a fee for mortgage advice. The actual amount you pay will depend upon your circumstances. The fee is up to 1% but a typical fee is 0.3% of the amount borrowed

MAB 6202



These particulars do not constitute any part of an offer or contract. None of the statements contained in these particulars are to be relied on as statements or representations of fact and any intending purchaser must satisfy himself by inspection or otherwise to the correctness of each of the statements contained in these particulars. The vendor does not make or give, and neither Nick & Gordon Carver Residential or Commercial, Nick & Gordon Carver, nor any person in their employment has any authority to make or give any representation or warranty whatever in relation to this property



14 Duke Street, Darlington
 County Durham, DL3 7AA
 Tel: 01325 357807
sales@carvergroup.co.uk

26 Market Place, Richmond
 North Yorkshire, DL10 4QG
 Tel: 01748 825317
richmond@carvergroup.co.uk

43 Dalton Way, Newton Aycliffe
 County Durham, DL5 4DJ
 Tel: 01325 320676
aycliffe@carvergroup.co.uk

219 High Street, Northallerton
 North Yorkshire, DL7 8LW
 Tel: 01609 777710
northallerton@carvergroup.co.uk

www.carvergroup.co.uk