



**CARVER**  
RESIDENTIAL  
Sales · Lettings · Property Management

Cestria Way  
Newton Aycliffe, DL5 7QU

**Offers in the region of £169,000**

House - Semi-Detached  
3 Bedroom/s  
2 Bathroom/s



A beautifully presented semi-detached property offering generous proportions throughout and featuring two reception rooms, large kitchen, en-suite shower room/WC and an integral single garage. Pleasantly situated on the popular Woodham Lea development the property would make a lovely family home and is equipped with uPVC double glazing and gas central heating to radiators. An internal viewing will reveal a living room, separate dining room, fitted kitchen/breakfast room, principal bedroom with en-suite shower room/WC, 2 further bedrooms and a family bathroom/WC. Externally there is an enclosed garden to the rear with two-care driveway leading to the integral garage.







### Agents Notes

Tenure:- Freehold

Mains gas, (central heating to radiators), electricity & drainage

uPVC double glazing throughout

Council Tax:- Band C

Local Authority:- Durham County Council

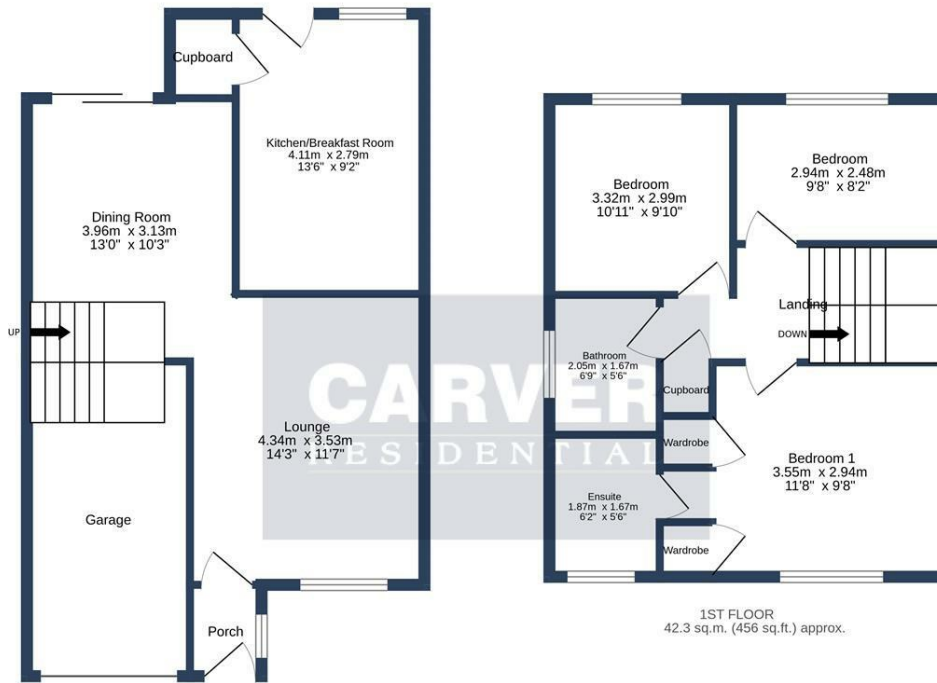

GROUND FLOOR  
52.7 sq.m. (567 sq.ft.) approx.

1ST FLOOR  
42.3 sq.m. (456 sq.ft.) approx.

CESTRIA WAY, NEWTON AYCLIFFE, DL5 7QU.

TOTAL FLOOR AREA: 95.0 sq.m. (1023 sq.ft.) approx.

Whilst every attempt has been made to ensure the accuracy of the floorplan contained here, measurements of doors, windows, rooms and any other items are approximate and no responsibility is taken for any error, omission or mis-statement. This plan is for illustrative purposes only and should be used as such by any prospective purchaser. The services, systems and appliances shown have not been tested and no guarantee as to their operability or efficiency can be given.  
Made with Metropix ©2024

Energy Efficiency Rating		Current	Potential
Very energy efficient - lower running costs			
(92 plus)	A		
(81-91)	B		
(69-80)	C		80
(55-68)	D	67	
(39-54)	E		
(21-38)	F		
(1-20)	G		
Not energy efficient - higher running costs			
England & Wales		EU Directive 2002/91/EC	

We can search 1,000s of mortgages for you

It could take just 15 minutes with one of our specialist advisers:  
Call: 01325 380088. Visit: Any of our Offices. Online: [www.mortgageadvicebureau.com/carver](http://www.mortgageadvicebureau.com/carver)



Your home may be repossessed if you do not keep up repayments on your mortgage. There will be a fee for mortgage advice. The actual amount you pay will depend upon your circumstances. The fee is up to 1% but a typical fee is 0.3% of the amount borrowed

MAB 6202



These particulars do not constitute any part of an offer or contract. None of the statements contained in these particulars are to be relied on as statements or representations of fact and any intending purchaser must satisfy himself by inspection or otherwise to the correctness of each of the statements contained in these particulars. The vendor does not make or give, and neither Nick & Gordon Carver Residential or Commercial, Nick & Gordon Carver, nor any person in their employment has any authority to make or give any representation or warranty whatever in relation to this property



14 Duke Street, Darlington  
County Durham, DL3 7AA  
Tel: 01325 357807  
sales@carvergroup.co.uk

26 Market Place, Richmond  
North Yorkshire, DL10 4QG  
Tel: 01748 825317  
richmond@carvergroup.co.uk

43 Dalton Way, Newton Aycliffe  
County Durham, DL5 4DJ  
Tel: 01325 320676  
aycliffe@carvergroup.co.uk

219 High Street, Northallerton  
North Yorkshire, DL7 8LW  
Tel: 01609 777710  
northallerton@carvergroup.co.uk

[www.carvergroup.co.uk](http://www.carvergroup.co.uk)