



**CARVER**  
RESIDENTIAL  
Sales · Lettings · Property Management

The Willows  
Middleton St. George, Darlington, DL2 1LP  
**Offers in the region of £180,000**

House - Townhouse  
3 Bedroom/s  
2 Bathroom/s



Welcome to The Willows in Middleton St. George! This townhouse, which is set over three floors, offers a delightful blend of comfort and style, perfect for those seeking a cozy yet spacious home. This home will be ideal for entertaining guests or simply relaxing with your loved ones. With three bedrooms and two bathrooms spread across three floors, there's plenty of space for the whole family to enjoy. Located in a popular village setting, this property offers easy access to the A66, making commuting towards Teesside or Darlington a breeze. The convenience of the location is further enhanced by the new boiler installed in 2021, ensuring warmth and comfort during the colder months. Recently having new carpets laid and redecorated throughout, this townhouse exudes a fresh and modern feel, ready for you to move in and make it your own. Don't miss out on the opportunity to make The Willows your new home sweet home in Middleton St. George.







- SET OVER THREE FLOORS
- LOW MAINTENANCE REAR GARDEN
- POPULAR VILLAGE LOCATION
- PARKING AND GARAGE
- VILLAGE SHOP NEARBY
- EASY ACCESS TO A66 AND DARLINGTON

**GENERAL INFORMATION:**

Tenure: Freehold

Services: Gas central heating (new boiler installed 2021), mains electric, water and drainage.  
Double glazing

Local Authority: Darlington Borough Council (Tax Banding C)

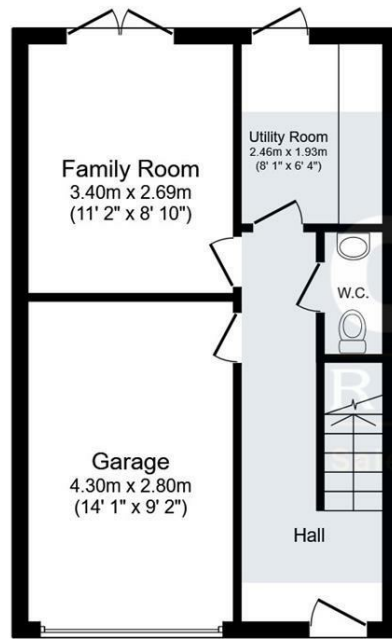

Ground Floor

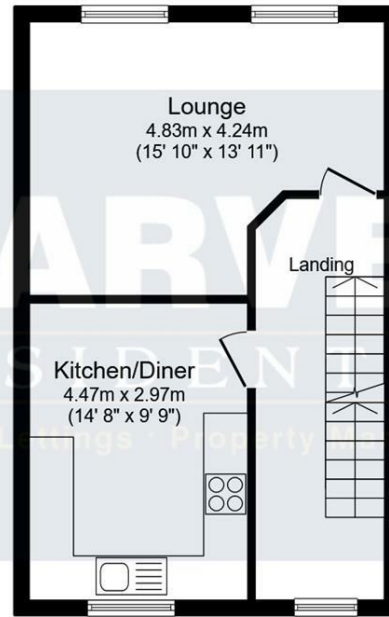

First Floor

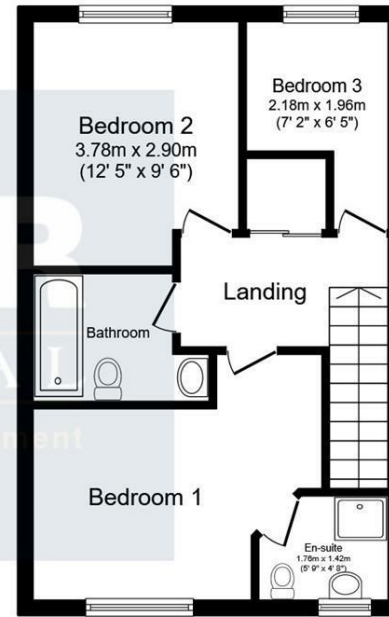

Second Floor

Energy Efficiency Rating		Current	Potential
Very energy efficient - lower running costs			
(92 plus) A			85
(81-91) B		76	
(69-80) C			
(55-68) D			
(39-54) E			
(21-38) F			
(1-20) G			
Not energy efficient - higher running costs			
England & Wales		EU Directive 2002/91/EC	

This floor plan is for illustrative purposes only. It is not drawn to scale. Any measurements, floor areas (including any total floor area), openings and orientations are approximate. No details are guaranteed, they cannot be relied upon for any purpose and do not form any part of any agreement. No liability is taken for any error, omission or misstatement. A party must rely upon its own inspection(s). Powered by www.Propertybox.io

We can search 1,000s of mortgages for you

It could take just 15 minutes with one of our specialist advisers:  
 Call: 01325 380088. Visit: Any of our Offices. Online: [www.mortgageadvicebureau.com/carver](http://www.mortgageadvicebureau.com/carver)



Your home may be repossessed if you do not keep up repayments on your mortgage. There will be a fee for mortgage advice. The actual amount you pay will depend upon your circumstances. The fee is up to 1% but a typical fee is 0.3% of the amount borrowed

MAB 6202



These particulars do not constitute any part of an offer or contract. None of the statements contained in these particulars are to be relied on as statements or representations of fact and any intending purchaser must satisfy himself by inspection or otherwise to the correctness of each of the statements contained in these particulars. The vendor does not make or give, and neither Nick & Gordon Carver Residential or Commercial, Nick & Gordon Carver, nor any person in their employment has any authority to make or give any representation or warranty whatever in relation to this property



14 Duke Street, Darlington  
 County Durham, DL3 7AA  
 Tel: 01325 357807  
[sales@carvergroup.co.uk](mailto:sales@carvergroup.co.uk)

26 Market Place, Richmond  
 North Yorkshire, DL10 4QG  
 Tel: 01748 825317  
[richmond@carvergroup.co.uk](mailto:richmond@carvergroup.co.uk)

43 Dalton Way, Newton Aycliffe  
 County Durham, DL5 4DJ  
 Tel: 01325 320676  
[aycliffe@carvergroup.co.uk](mailto:aycliffe@carvergroup.co.uk)

219 High Street, Northallerton  
 North Yorkshire, DL7 8LW  
 Tel: 01609 777710  
[northallerton@carvergroup.co.uk](mailto:northallerton@carvergroup.co.uk)