



**CARVER**  
RESIDENTIAL  
Sales · Lettings · Property Management

Chatsworth Terrace  
Darlington, DL1 5DH

**Offers in the region of £115,000**

House - Terraced  
3 Bedroom/s  
1 Bathroom/s

A spacious property located on Chatsworth Terrace in Darlington! This delightful terraced house boasts 2 reception rooms, 3 bedrooms and 1 bathroom, making it a perfect family home. Situated in a prime location, this property offers a spacious interior with plenty of room for all your needs. Being an end terrace, you'll enjoy extra privacy and a sense of exclusivity. One of the highlights of this property is its proximity to the picturesque South Park, where you can enjoy leisurely strolls and picnics in the beautiful surroundings. Additionally, the convenience of being within walking distance to the town centre means you have easy access to shops, restaurants, and other amenities. For those who rely on public transport, the train station is just a 5-minute walk away, providing excellent connectivity to other parts of the country. Don't miss out on the opportunity to own this lovely home in a sought-after location that offers both comfort and convenience. Contact us today to arrange a viewing and make this property your new dream home!





- CLOSE TO SOUTH PARK
- TOWN CENTRE EASILY WALKABLE
- SPACIOUS HOME
- TRAIN STATION WITHIN 5 MINUTES WALK
- END TERRACE

**GENERAL INFORMATION:**

Tenure: Freehold

Services: Gas central heating, mains electric, water and drainage.

Double glazing

Local Authority: Darlington Borough Council (Tax Banding A)

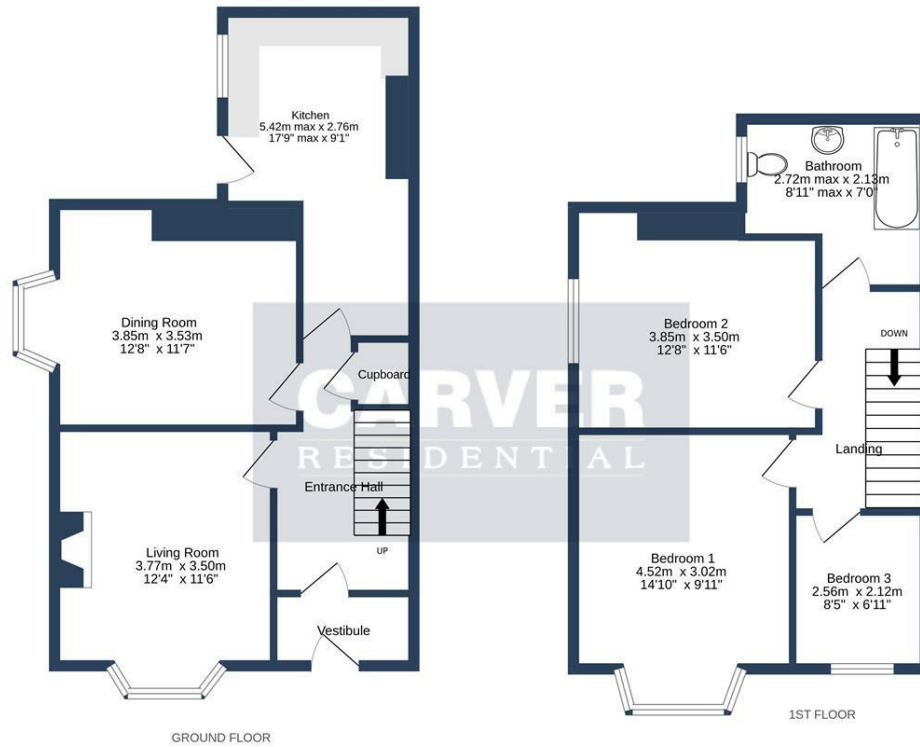

CHATSWORTH TERRACE, DARLINGTON. DL1 5DH.

Whilst every attempt has been made to ensure the accuracy of the floorplan contained here, measurements of doors, windows, rooms and any other items are approximate and no responsibility is taken for any error, omission or mis-statement. This plan is for illustrative purposes only and should be used as such by any prospective purchaser. The services, systems and appliances shown have not been tested and no guarantee as to their operability or efficiency can be given. Made with Metropix. ©2024

Energy Efficiency Rating		
	Current	Potential
Very energy efficient - lower running costs		
(92 plus) <b>A</b>		
(81-91) <b>B</b>		
(69-80) <b>C</b>		69
(55-68) <b>D</b>		
(39-54) <b>E</b>	46	
(21-38) <b>F</b>		
(1-20) <b>G</b>		
Not energy efficient - higher running costs		
<b>England &amp; Wales</b>		EU Directive 2002/91/EC

**We can search 1,000s of mortgages for you**

It could take just 15 minutes with one of our specialist advisers:  
 Call: 01325 380088. Visit: Any of our Offices. Online: [www.mortgageadvicebureau.com/carver](http://www.mortgageadvicebureau.com/carver)



Your home may be repossessed if you do not keep up repayments on your mortgage. There will be a fee for mortgage advice. The actual amount you pay will depend upon your circumstances. The fee is up to 1% but a typical fee is 0.3% of the amount borrowed

MAB 6202



These particulars do not constitute any part of an offer or contract. None of the statements contained in these particulars are to be relied on as statements or representations of fact and any intending purchaser must satisfy himself by inspection or otherwise to the correctness of each of the statements contained in these particulars. The vendor does not make or give, and neither Nick & Gordon Carver Residential or Commercial, Nick & Gordon Carver, nor any person in their employment has any authority to make or give any representation or warranty whatever in relation to this property



14 Duke Street, Darlington  
 County Durham, DL3 7AA  
 Tel: 01325 357807  
[sales@carvergroup.co.uk](mailto:sales@carvergroup.co.uk)

26 Market Place, Richmond  
 North Yorkshire, DL10 4QG  
 Tel: 01748 825317  
[richmond@carvergroup.co.uk](mailto:richmond@carvergroup.co.uk)

43 Dalton Way, Newton Aycliffe  
 County Durham, DL5 4DJ  
 Tel: 01325 320676  
[aycliffe@carvergroup.co.uk](mailto:aycliffe@carvergroup.co.uk)

219 High Street, Northallerton  
 North Yorkshire, DL7 8LW  
 Tel: 01609 777710  
[northallerton@carvergroup.co.uk](mailto:northallerton@carvergroup.co.uk)

[www.carvergroup.co.uk](http://www.carvergroup.co.uk)