



**CARVER**  
RESIDENTIAL  
Sales · Lettings · Property Management

Marina Road  
Darlington, DL3 0AN

**Offers in the region of £158,000**

House - Semi-Detached  
3 Bedroom/s  
1 Bathroom/s

Nestled in the sought-after Harrowgate Hill area, this semi-detached house on Marina Road is a true gem waiting to be discovered. Boasting three bedrooms two having fitted wardrobes, and two reception rooms, this property offers ample space, and would be ideally suited to the needs of a family.

Convenience is key with this home, as it is within walking distance to schools and shops, making daily errands a breeze. The fitted extended kitchen is perfect for whipping up delicious meals, while the mature, established gardens provide a tranquil retreat for relaxation or for all the family to enjoy, the West facing rear garden is perfect to enjoy the summer sunshine.

Offered for sale with no onward chain, this property presents a fantastic opportunity to make it your own without any delays. Additionally, the presence of a garage adds to the practicality and storage options this home provides.

Don't miss out on the chance to own this delightful semi-detached house in a popular location. Please note that the property is also well placed for easy access to the A1M.





- NO ONWARD CHAIN
- WELL MAINTAINED
- TWO RECEPTION ROOMS
- THREE BEDROOMS
- MATURE, ESTABLISHED GARDENS
- POPULAR HARROWGATE HILL LOCATION
- WALKING DISTANCE TO SCHOOLS, SHOPS, ETC
- EXTENDED KITCHEN
- GARAGE

**GENERAL INFORMATION:**

Tenure: Freehold

Services: Gas central heating, mains electric, water and drainage.

Double glazing

Local Authority: Darlington Borough Council (Tax Banding B)

### Ground Floor

Approx. 44.5 sq. metres (479.0 sq. feet)

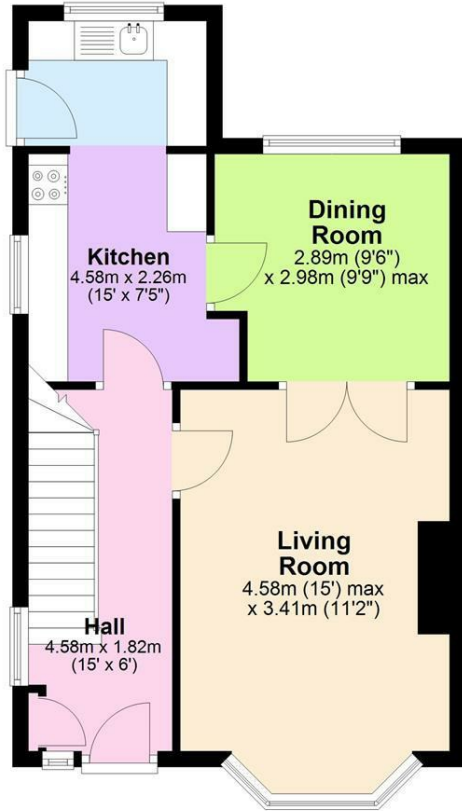

### First Floor

Approx. 49.3 sq. metres (530.3 sq. feet)

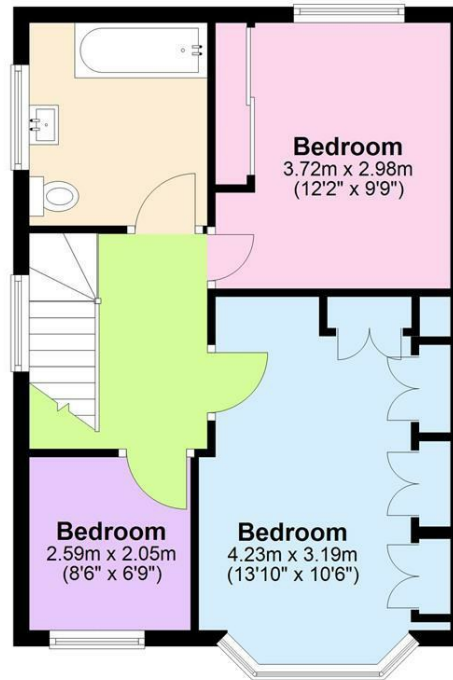

Total area: approx. 93.8 sq. metres (1009.3 sq. feet)

**63 Marina Road, Darlington**

Energy Efficiency Rating		
	Current	Potential
Very energy efficient - lower running costs		
(92 plus) <b>A</b>		
(81-91) <b>B</b>		
(69-80) <b>C</b>		
(55-68) <b>D</b>		
(39-54) <b>E</b>		
(21-38) <b>F</b>		
(1-20) <b>G</b>		
Not energy efficient - higher running costs		
<b>England &amp; Wales</b>		EU Directive 2002/91/EC

**We can search 1,000s of mortgages for you**

It could take just 15 minutes with one of our specialist advisers:  
Call: 01325 380088. Visit: Any of our Offices. Online: [www.mortgageadvicebureau.com/carver](http://www.mortgageadvicebureau.com/carver)



Your home may be repossessed if you do not keep up repayments on your mortgage. There will be a fee for mortgage advice. The actual amount you pay will depend upon your circumstances. The fee is up to 1% but a typical fee is 0.3% of the amount borrowed

MAB 6202



These particulars do not constitute any part of an offer or contract. None of the statements contained in these particulars are to be relied on as statements or representations of fact and any intending purchaser must satisfy himself by inspection or otherwise to the correctness of each of the statements contained in these particulars. The vendor does not make or give, and neither Nick & Gordon Carver Residential or Commercial, Nick & Gordon Carver, nor any person in their employment has any authority to make or give any representation or warranty whatever in relation to this property



**14 Duke Street, Darlington**  
Co Durham, DL3 7AA  
01325 357807  
[sales@carvergroup.co.uk](mailto:sales@carvergroup.co.uk)

**43 Dalton Way, Newton Aycliffe**  
Co Durham DL5 4DJ  
01325 320676  
[aycliffe@carvergroup.co.uk](mailto:aycliffe@carvergroup.co.uk)

**41 Market Place, Richmond**  
North Yorkshire, DL10 4QL  
01748 825317  
[richmond@carvergroup.co.uk](mailto:richmond@carvergroup.co.uk)

**219 High Street, Northallerton**  
North Yorkshire DL7 8LW  
01609 777710  
[northallerton@carvergroup.co.uk](mailto:northallerton@carvergroup.co.uk)