

Whashton Richmond DL11 7JP Price £475,000



**CARVER**  
RESIDENTIAL  
Sales · Lettings · Property Management

Located just on the outskirts of the picturesque village of Whashton, Drystones offers a delightful 3-bedroom detached bungalow set on a generous plot. This inviting property, while requiring a touch of updating, presents a fantastic opportunity to create your dream home.

Inside, you will find a bright and airy dual aspect lounge flooded with natural light, a charming country-style kitchen with adjoining dining room perfect for family gatherings, three generous bedrooms, and family bathroom with separate w/c.

Externally, the property boasts extensive cottage-style gardens that provide a peaceful retreat, perfect for gardening enthusiasts or those who simply enjoy outdoor living, and for those with multiple vehicles or in need of workshop space, Drystones boasts an attached double garage and a separate garage/workshop offering ample storage or potential for further development along with ample parking space for several vehicles, making this home as practical as it is picturesque.

With its combination of character, space, and potential, Drystones is a rare find in a sought-after location presenting a fantastic opportunity to create a personalised space.







- Double garage
- Workshop
- Large Garden
- Detached Bungalow
- 3 Bedrooms
- Potential to Extend
- Lovely Views

General Remarks  
Tenure: Freehold

Services: Oil C/H, Mains Water, Mains Electric,  
Septic Tank c1981 (will not comply with current  
2020 regulation and may need updating)  
Council Tax: Band D £2237 North Yorkshire CC





**CARVER**  
RESIDENTIAL  
Sales · Lettings · Property Management



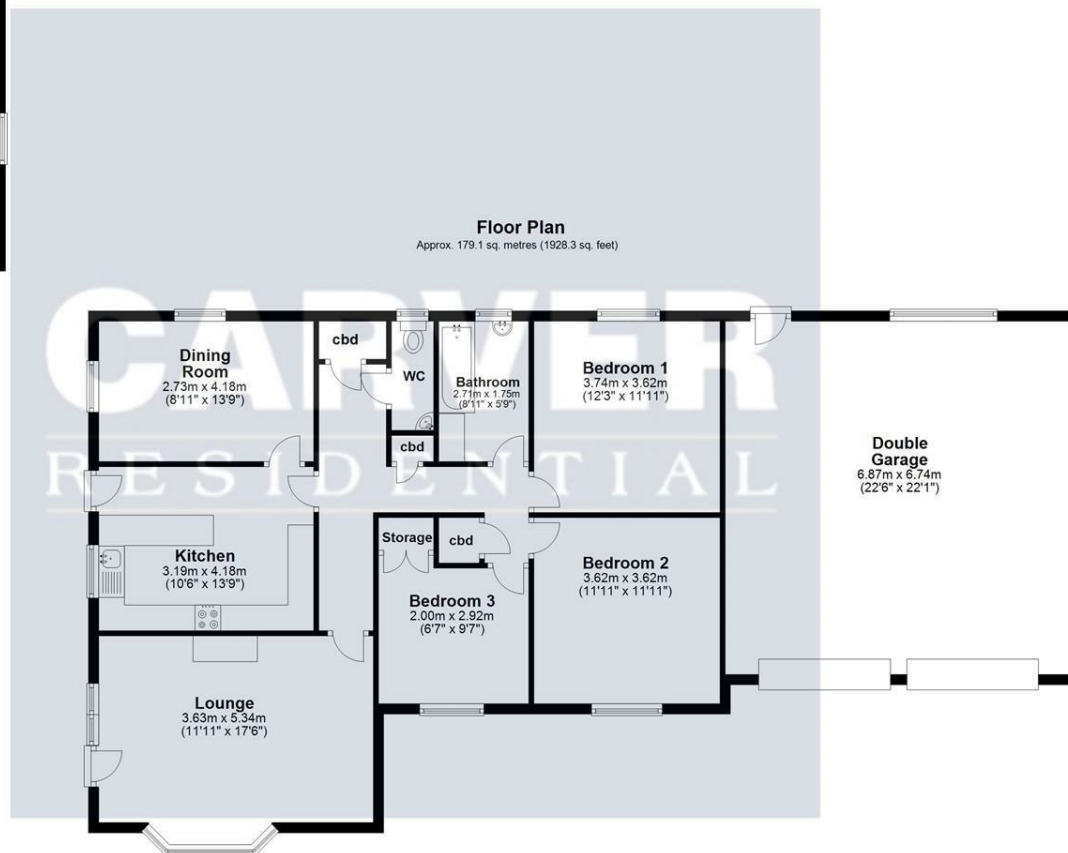

Total area: approx. 179.1 sq. metres (1928.3 sq. feet)

Sketch Plan: Not To Scale. For Illustrative Purposes Only. Created by HJ Cadplan Ltd.  
Plan produced using PlanUp.

Energy Efficiency Rating		Current	Potential
Very energy efficient - lower running costs			
(92 plus) <b>A</b>			
(81-91) <b>B</b>			
(69-80) <b>C</b>			
(55-68) <b>D</b>			
(39-54) <b>E</b>		46	
(21-38) <b>F</b>			
(1-20) <b>G</b>			
Not energy efficient - higher running costs			
<b>England &amp; Wales</b>		EU Directive 2002/91/EC	

**We can search 1,000s of mortgages for you**

It could take just 15 minutes with one of our specialist advisers:  
Call: 01325 380088. Visit: Any of our Offices. Online: [www.mortgageadvicebureau.com/carver](http://www.mortgageadvicebureau.com/carver)



Your home may be repossessed if you do not keep up repayments on your mortgage. There will be a fee for mortgage advice. The actual amount you pay will depend upon your circumstances. The fee is up to 1% but a typical fee is 0.3% of the amount borrowed

MAB 6202



These particulars do not constitute any part of an offer or contract. None of the statements contained in these particulars are to be relied on as statements or representations of fact and any intending purchaser must satisfy himself by inspection or otherwise to the correctness of each of the statements contained in these particulars. The vendor does not make or give, and neither Nick & Gordon Carver Residential or Commercial, Nick & Gordon Carver, nor any person in their employment has any authority to make or give any representation or warranty whatever in relation to this property

80 High Street  
Yarm, TS15 9AH  
Tel: 01642 420090  
[yarm@carvergroup.co.uk](mailto:yarm@carvergroup.co.uk)

14 Duke Street, Darlington  
County Durham, DL3 7AA  
Tel: 01325 357807  
[sales@carvergroup.co.uk](mailto:sales@carvergroup.co.uk)

26 Market Place, Richmond  
North Yorkshire, DL10 4QG  
Tel: 01748 825317  
[richmond@carvergroup.co.uk](mailto:richmond@carvergroup.co.uk)

43 Dalton Way, Newton Aycliffe  
County Durham, DL5 4DJ  
Tel: 01325 320676  
[aycliffe@carvergroup.co.uk](mailto:aycliffe@carvergroup.co.uk)

219 High Street, Northallerton  
North Yorkshire, DL7 8LW  
Tel: 01609 777710  
[northallerton@carvergroup.co.uk](mailto:northallerton@carvergroup.co.uk)