



*Strands Farmhouse Gunnerside, Richmond, DL11 6LF
Offers in the region of £575,000*

CARVER
RESIDENTIAL
Sales · Lettings · Property Management

Strands Farmhouse, is an fabulous example of a PERIOD DALES HOUSE nestled in the picturesque village of Strands on the outskirts of Gunnerside, North Yorkshire. This traditional farmhouse is a charming blend of historical elegance and modern comfort, offering stunning views over the surrounding open countryside.

Strands Farmhouse boasts four bedrooms, each offering beautiful views and adorned with feature fireplaces that add a touch of classic character, all of which are served by an elegant bathroom with traditional fixtures and fittings and a luxurious freestanding, roll top bath. The heart of the home will most likely be the open-plan kitchen diner, complete with a log burner which is perfect for family gatherings and entertaining. Across the entrance hallway is a separate utility room which houses the boiler along with a ground floor w/c for added convenience. The cosy lounge has a wonderful fireplace with log burner providing a warm and inviting space for relaxation.

In addition to the main house, the property includes a delightful one-bedroom cottage with an en suite shower room, ideal for guests or potential rental income. The extensive outbuildings comprise a versatile workshop and spacious gym/home office with a sauna and shower room, catering to all your lifestyle needs.

Externally, the farmhouse is accessed via a gated driveway that offers generous parking space. The tiered south-west facing gardens are a horticultural delight, with mature planting, serene patio areas, and sweeping views that make outdoor living a pleasure.

















Living in Strands Farmhouse provides the perfect opportunity to immerse yourself in the idyllic charm and natural splendour of North Yorkshire, creating a haven of peace and relaxation where you can experience the changing seasons in all their glory.

Strands is a charming and peaceful village situated on the outskirts of Gunnerside, in the heart of the stunning North Yorkshire Dales. Known for its breathtaking landscapes, this area offers a serene retreat from the hustle and bustle of city life. The surrounding countryside is a paradise for outdoor enthusiasts, with endless opportunities for walking, cycling, and exploring the natural beauty of the Dales.



Energy Efficiency Rating		
	Current	Potential
Very energy efficient - lower running costs		
(92 plus) A		82
(81-91) B		
(69-80) C		
(55-68) D	60	
(39-54) E		
(21-38) F		
(1-20) G		
Not energy efficient - higher running costs		
England & Wales	EU Directive 2002/91/EC	

Environmental Impact (CO ₂) Rating		
	Current	Potential
Very environmentally friendly - lower CO ₂ emissions		
(92 plus) A		
(81-91) B		
(69-80) C		
(55-68) D		
(39-54) E		
(21-38) F		
(1-20) G		
Not environmentally friendly - higher CO ₂ emissions		
England & Wales	EU Directive 2002/91/EC	



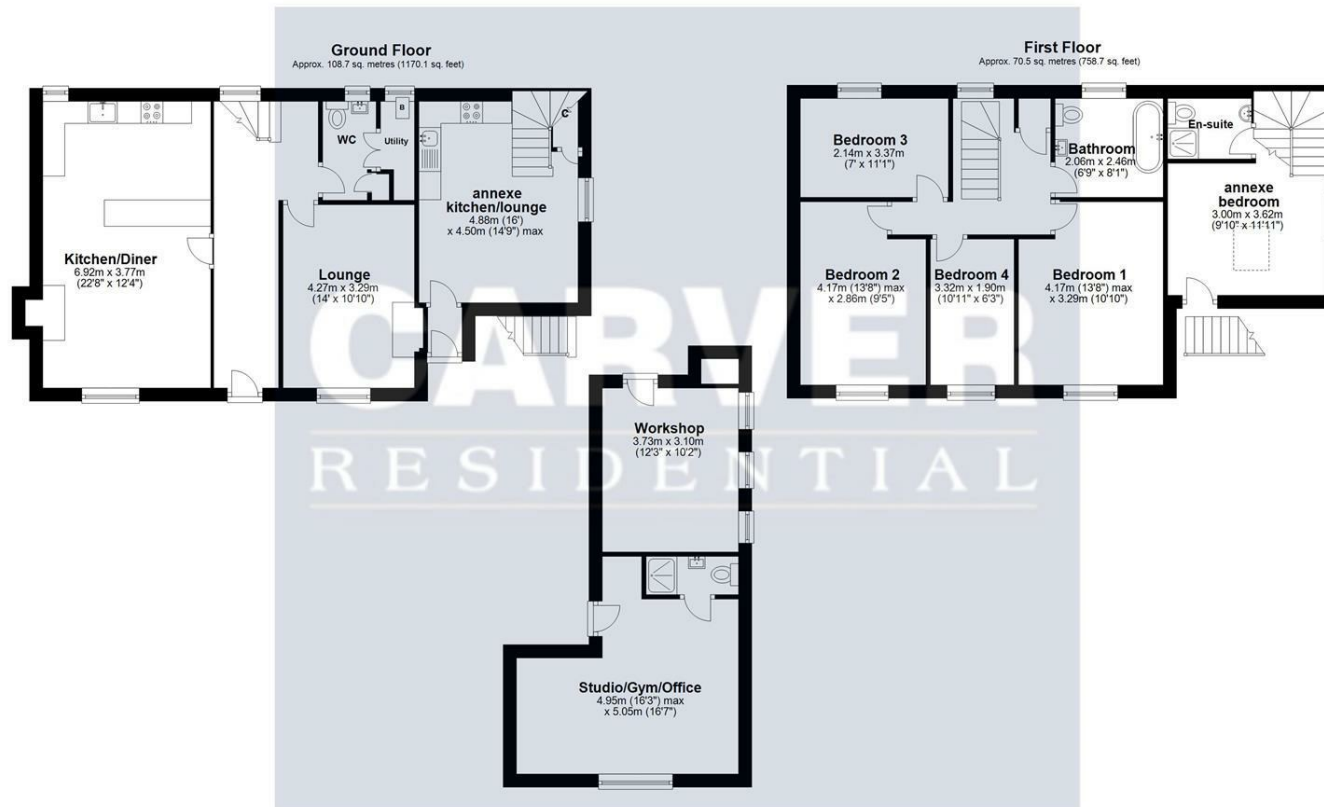

Total area: approx. 179.2 sq. metres (1928.8 sq. feet)

Sketch Plan: Not To Scale. For Illustrative Purposes Only. Created by HJ Cadplan Ltd.
Plan produced using PlanUp.

naea
propertymark

PROTECTED



CARVER
RESIDENTIAL
Sales · Lettings · Property Management

41 Market Place
Richmond
North Yorkshire
DL10 4QL

01748 825317 richmond@carvergroup.co.uk