



**CARVER**  
RESIDENTIAL  
Sales · Lettings · Property Management

Fernwood Close  
Brompton, Northallerton, DL6 2UX

**Offers in the region of £135,000**

Bungalow - Detached  
2 Bedroom/s  
1 Bathroom/s

70% share of a well presented two bedroomed detached bungalow with front and rear gardens and garage / store. The property benefits from electric heating and double glazing. The accommodation includes an entrance hall, cloak room / wc, spacious living room / dining room, kitchen fitted with high gloss white wall and base units, inner hall, two double bedrooms and a wat room. Externally there is a driveway providing off street parking and access to the garage / store. There are also front and rear gardens. The property is well positioned within a cul de sac location.

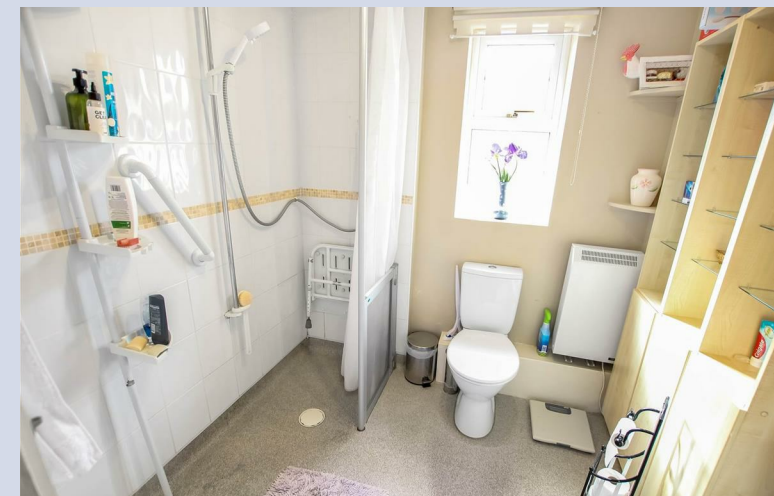



- Two bedroomed detached bungalow
- Double glazing and electric heating
- Modern fitted kitchen
- Off street parking and access to a garage / store
- 70% Share available. Buyers must be 55 yrs plus
- Spacious living room / dining room
- Front and rear gardens
- Popular village location

**GENERAL INFORMATION**

Tenure: Leasehold. New 99 year lease from completion of purchase. Current service charge £601.60

Services: Electric heating, mains electric, water and drainage.

Double glazing

Local Authority: North Yorkshire Band C

70% Share. Buyers must be 55 yrs plus, Not own any other property and not have an income of more than £80,000.

30% Share owned by Accent Housing Association.

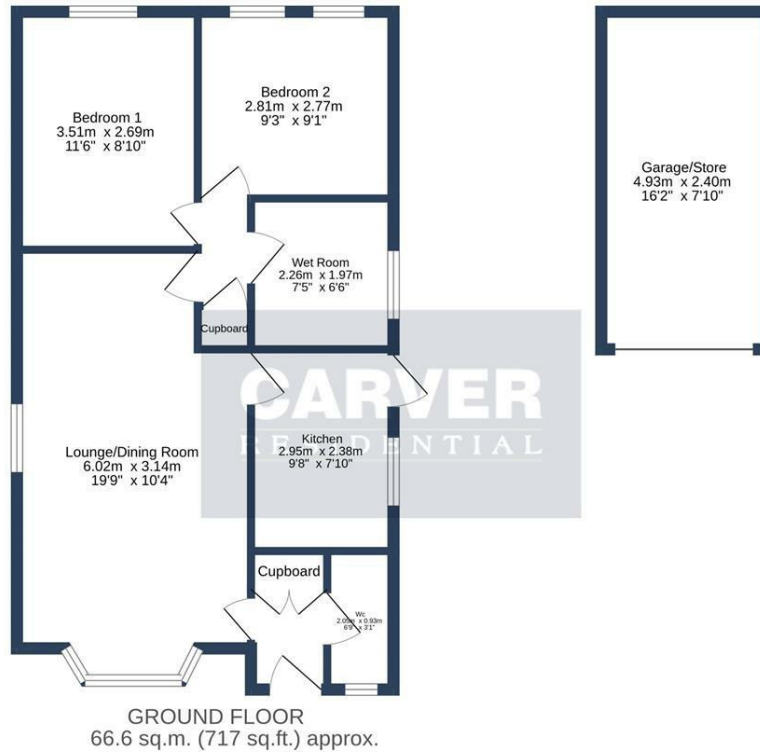

FERNWOOD CLOSE, BROMPTON, DL6 2UX.

TOTAL FLOOR AREA - 66.6 sq.m. (717 sq.ft.) approx.

Whilst every attempt has been made to ensure the accuracy of the floorplan contained herein, measurements of doors, windows, rooms and any other items are approximate and no responsibility is taken for any error, omission or mis-statement. This plan is for illustrative purposes only and should be used as such by any prospective purchaser. The services, systems and appliances shown have not been tested and no guarantee as to their operability or efficiency can be given.  
Made with Metropix ©2024

Energy Efficiency Rating		
	Current	Potential
Very energy efficient - lower running costs		
(92 plus) <b>A</b>		<b>85</b>
(81-91) <b>B</b>		
(69-80) <b>C</b>		
(55-68) <b>D</b>		
(39-54) <b>E</b>	<b>53</b>	
(21-38) <b>F</b>		
(1-20) <b>G</b>		
Not energy efficient - higher running costs		
<b>England &amp; Wales</b>	EU Directive 2002/91/EC	

We can search 1,000s of mortgages for you

It could take just 15 minutes with one of our specialist advisers:  
Call: 01325 380088. Visit: Any of our Offices. Online: [www.mortgageadvicebureau.com/carver](http://www.mortgageadvicebureau.com/carver)



Your home may be repossessed if you do not keep up repayments on your mortgage. There will be a fee for mortgage advice. The actual amount you pay will depend upon your circumstances. The fee is up to 1% but a typical fee is 0.3% of the amount borrowed

MAB 6202



These particulars do not constitute any part of an offer or contract. None of the statements contained in these particulars are to be relied on as statements or representations of fact and any intending purchaser must satisfy himself by inspection or otherwise to the correctness of each of the statements contained in these particulars. The vendor does not make or give, and neither Nick & Gordon Carver Residential or Commercial, Nick & Gordon Carver, nor any person in their employment has any authority to make or give any representation or warranty whatever in relation to this property



14 Duke Street, Darlington  
County Durham, DL3 7AA  
Tel: 01325 357807  
[sales@carvergroup.co.uk](mailto:sales@carvergroup.co.uk)

26 Market Place, Richmond  
North Yorkshire, DL10 4QG  
Tel: 01748 825317  
[richmond@carvergroup.co.uk](mailto:richmond@carvergroup.co.uk)

43 Dalton Way, Newton Aycliffe  
County Durham, DL5 4DJ  
Tel: 01325 320676  
[aycliffe@carvergroup.co.uk](mailto:aycliffe@carvergroup.co.uk)

219 High Street, Northallerton  
North Yorkshire, DL7 8LW  
Tel: 01609 777710  
[northallerton@carvergroup.co.uk](mailto:northallerton@carvergroup.co.uk)

[www.carvergroup.co.uk](http://www.carvergroup.co.uk)