

OAK MEADOWS



3

1339 SQ FT

THE CHESTNUT

3 BEDROOM SEMI-DETACHED HOUSE

 Calmont
Homes

WWW.OAKMEADOWS.CO.UK

A home which brings the outdoors inside with its cosy roof terrace expanding along the length of the property. The Chestnut is a large detached property featuring three double bedrooms.

Complete with floor to ceiling windows, high ceilings, and additional storage space on each floor of the property, this generously sized family home has multiple living spaces for all to enjoy.

Premium, triple glazed aluminium and timber Vefac windows and external doors come as standard in every one of our properties. Buyers can choose from a selection of fitted kitchens all with integrated Bosch appliances and Porcelanosa bathrooms.

Buyers will also be able to select their own contemporary home flooring, tiling and decorative features alongside any of our dedicated paint colours that they wish to be used throughout the property, all of which have been curated for Oak Meadows by our interior designer.

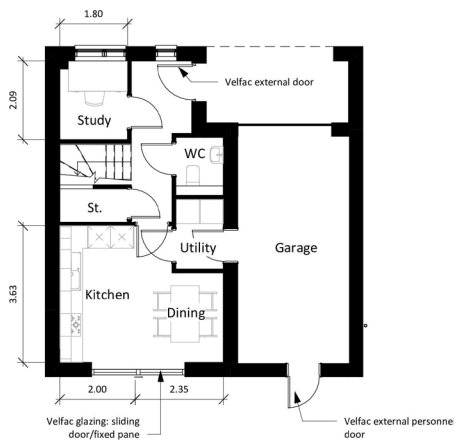

GROUND FLOOR

Enjoy an open plan kitchen diner with Vefac sliding doors leading to the garden, alongside a study space, utility and cloakroom. The ground floor also boasts a large garage perfect for additional storage.

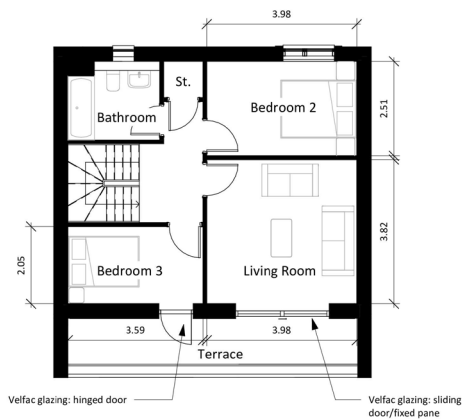

FIRST FLOOR

A grand living room opens into a cosy roof terrace, bringing the outdoors inside and creating a serene contemporary living space. The floor also features two generous double bedrooms and a family bathroom.

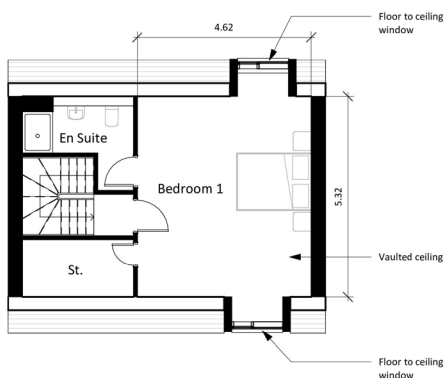

SECOND FLOOR

The master suite, complete with floor to ceiling windows, a luxury ensuite bathroom and an additional walk-in wardrobe.

Images shown are for illustrative purposes only. Although Calmont Homes has made every effort to ensure accuracy of information contained in this brochure, we reserve the right to amend and update the specification or layout without prior notification. The information contained herein is for guidance only and its accuracy is not guaranteed. They do not constitute a contract, part of a contract or warranty. External finishes may vary from those shown and dimensions given are approximate (measured to the widest part) and we cannot be held responsible if sizes vary from those indicated. Fireplaces (where shown) are not included in our usual specification. Please consult our Sales Executive with regards to specification and specific plots. You should take appropriate advice to verify any information on which you wish to rely.