



**CARVER**  
RESIDENTIAL  
Sales · Lettings · Property Management

Ashlands Road  
Northallerton, DL6 1HD

**Offers in the region of £159,950**

House - Terraced  
3 Bedroom/s  
1 Bathroom/s



A spacious three bedroomed end terraced family home situated on a good sized corner site with gardens to the front, side and rear. The property benefits from gas fired central heating and double glazing and the accommodation includes an entrance porch, spacious living room, good sized kitchen / dining room with high gloss wall and base units together with integrated oven, hob and fridge freezer. There is a rear hall and access to a wc / utility room. To the first floor there are storage cupboards on the landing, both bedrooms one and two are double rooms with built in wardrobes. Bedroom three is a single room with built in cupboard. The shower room is fitted with a shower cubical and has tiled walls and floor. Externally there is a shared footpath leading to the front door. The gardens are to the front, side and rear with lawn and patio areas together with a garden store.







- Three bedroomed end terraced property
- Lovely living room with laminate floor covering
- High gloss wall and base units with integrated oven, hob and fridge freezer
- Shower room with tiled walls and floor
- Popular residential location
- Good sized corner plot with gardens front, side and rear
- Spacious kitchen / dining room
- Down stairs wc
- Three good sized bedrooms
- Potential to extend subject to any planning permission / building regulations

#### GENERAL INFORMATION

Tenure: Freehold

Services: Gas central heating, mains electric, water and drainage.

Double glazing.

Local Authority: Band B North Yorkshire

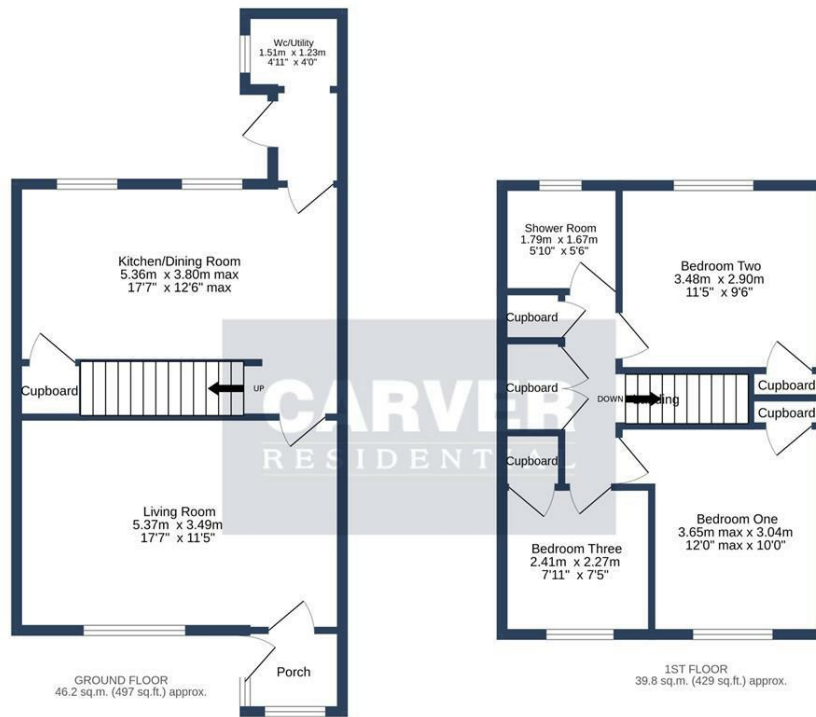

ASHLANDS ROAD, NORTHALLERTON, DL6 1HD.

TOTAL FLOOR AREA: 86.0 sq.m. (926 sq.ft.) approx.

Whilst every attempt has been made to ensure the accuracy of the floorplans contained here, measurements of doors, windows, rooms and any other items are approximate and no responsibility is taken for any error, omission or mis-statement. This plan is for illustrative purposes only and should be used as such by any prospective purchaser. The services, systems and appliances shown have not been tested and no guarantee as to their operability or efficiency can be given. Made with Metropix ©2024

Energy Efficiency Rating		
	Current	Potential
Very energy efficient - lower running costs		
(92 plus) <b>A</b>		<b>85</b>
(81-91) <b>B</b>		
(69-80) <b>C</b>	<b>69</b>	
(55-68) <b>D</b>		
(39-54) <b>E</b>		
(21-38) <b>F</b>		
(1-20) <b>G</b>		
Not energy efficient - higher running costs		
<b>England &amp; Wales</b>		EU Directive 2002/91/EC

**We can search 1,000s of mortgages for you**

It could take just 15 minutes with one of our specialist advisers:  
 Call: 01325 380088. Visit: Any of our Offices. Online: [www.mortgageadvicebureau.com/carver](http://www.mortgageadvicebureau.com/carver)



Your home may be repossessed if you do not keep up repayments on your mortgage. There will be a fee for mortgage advice. The actual amount you pay will depend upon your circumstances. The fee is up to 1% but a typical fee is 0.3% of the amount borrowed

MAB 6202



These particulars do not constitute any part of an offer or contract. None of the statements contained in these particulars are to be relied on as statements or representations of fact and any intending purchaser must satisfy himself by inspection or otherwise to the correctness of each of the statements contained in these particulars. The vendor does not make or give, and neither Nick & Gordon Carver Residential or Commercial, Nick & Gordon Carver, nor any person in their employment has any authority to make or give any representation or warranty whatever in relation to this property



14 Duke Street, Darlington  
 County Durham, DL3 7AA  
 Tel: 01325 357807  
[sales@carvergroup.co.uk](mailto:sales@carvergroup.co.uk)

26 Market Place, Richmond  
 North Yorkshire, DL10 4QG  
 Tel: 01748 825317  
[richmond@carvergroup.co.uk](mailto:richmond@carvergroup.co.uk)

43 Dalton Way, Newton Aycliffe  
 County Durham, DL5 4DJ  
 Tel: 01325 320676  
[aycliffe@carvergroup.co.uk](mailto:aycliffe@carvergroup.co.uk)

219 High Street, Northallerton  
 North Yorkshire, DL7 8LW  
 Tel: 01609 777710  
[northallerton@carvergroup.co.uk](mailto:northallerton@carvergroup.co.uk)

[www.carvergroup.co.uk](http://www.carvergroup.co.uk)